



23001 Industrial Blvd, Rogers, MN 55374 / 1-866-527-7637
www.motoalliance.com

DENALI Plow Mount MA11792 John Deere Gator XUV 590i

Thank you for purchasing a DENALI plow mount. You now own a premium, custom plow mount to allow you to use your plow with your UTV/SxS. Please note the following instructions and heed all warnings.

- Your UTV/SxS and/or plow system can cause death or injury. Please use caution and common sense when operating your unit.
- Read your Plow Operator Manual, your Winch Operator Manual, and all warning labels before operating your UTV/SxS.
- Operate your UTV/SxS at a walking speed with the blade installed. Do not exceed 5 mph (8 km/h) even with the blade up.
- Do not operate the UTV/SxS on slopes greater than 10 degrees with the plow installed.
- Always lower the plow to the down position before leaving your UTV/SxS unattended.

SEVERE INJURY OR DEATH MAY RESULT IF YOU ARE NEGLIGENT.

Please verify that all hardware and parts are included in your package.

MA11792

DENALI John Deere Gator XUV 590i Plow Mount



motoalliance

23001 Industrial Blvd

Rogers, MN 55374

866.527.7637

Kit Contents:

Part #	Qty	Description
1	1	MA11792 Plow Mount
2	1	RH "Z" Bracket
3	1	LH "Z" Bracket
4	8	3/8 x 1" Serrated Flange Bolt
5	8	3/8" Serrated Flange Nut

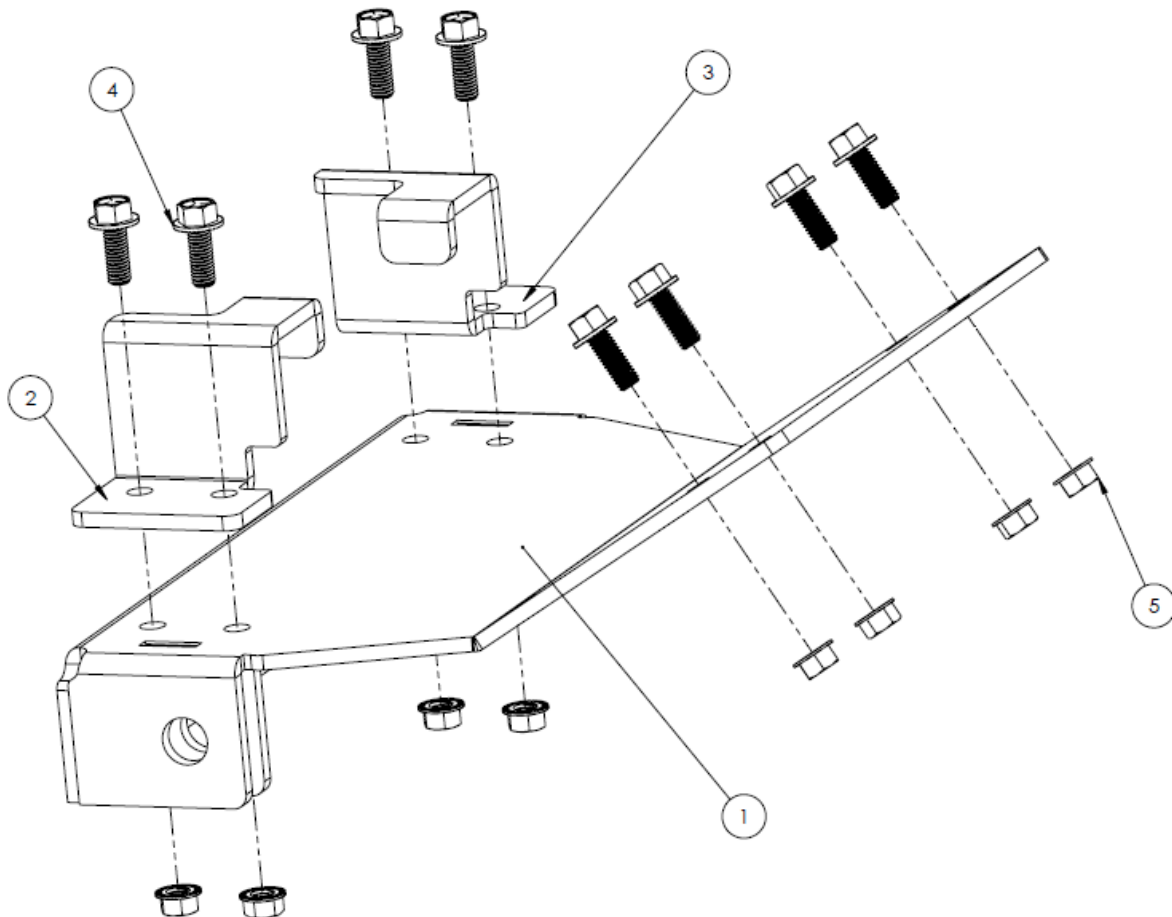

MA11792 Assembly View

MA11792

DENALI John Deere Gator XUV 590i Plow Mount



motoalliance

23001 Industrial Blvd

Rogers, MN 55374

866.527.7637

1. Hang the RH "Z" Bracket (part #2) and LH "Z" Bracket (part #3) on the square tube frame between the A-Arms as shown in Figure 1. Make sure the notched edge of the "Z" Bracket faces the rear of the machine.

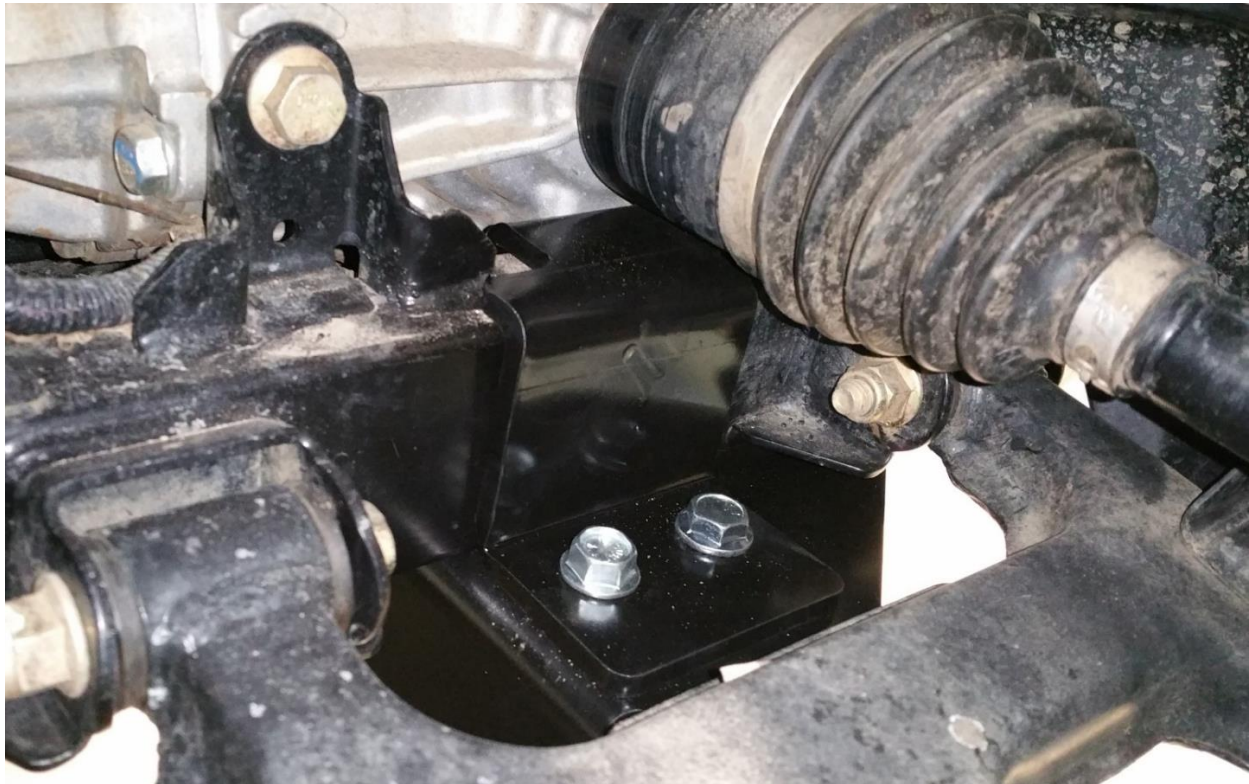

Figure 1

2. Hang two (2) of the 3/8 x 1" Serrated Flange Bolts (part #4) from the RH "Z" Bracket (part #2) and two (2) of the 3/8 x 1" Serrated Flange Bolts (part #4) LH "Z" Bracket (part #3).

MA11792

DENALI John Deere Gator XUV 590i Plow Mount



motoalliance

23001 Industrial Blvd

Rogers, MN 55374

866.527.7637

3. Lift the MA11792 Plow Mount (part #1) into place as shown in Figure 2. Secure with four (4) 3/8" Serrated Flange Nuts (part #5) but do not tighten down at this time.



Figure 2

4. Secure the front tab of the MA11792 Plow Mount (part #1) with the remaining four (4) 3/8 x 1" Serrated Flange Bolts (part #4) and the remaining four (4) 3/8" Serrated Flange Nuts (part #5) and tighten all hardware down.
5. Attach the plow using the quick release pins included with DENALI Plow Kits.

After First Time Use

After the first use of your plow, check and retighten all hardware at least once, in case your frame has flexed and the Plow Mount has loosened.